

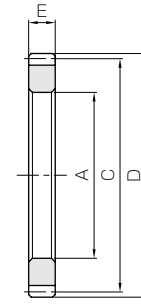

| Specifications  |   |
|-----------------|---|
| Precision grade | JIS grade N9 (JIS B1702-1: 1998)<br>JIS grade 5 (JIS B1702: 1976) |
| Gear teeth      | Standard full depth   |
| Pressure angle  | 20°   |
| Material        | S45C  |
| Heat treatment  | —   |
| Tooth hardness  | less than 194HB   |



S5

| Catalog No.       | Module      | No. of teeth | Shape | Bore            |     | Pitch dia. |    | Outside dia.     |                    | Face width       |                    | Allowable torque (N·m) |  | Allowable torque (kgf·m) |  |
|-------------------|-------------|--------------|-------|-----------------|-----|------------|----|------------------|--------------------|------------------|--------------------|------------------------|--|--------------------------|--|
|                   |             |              |       | A <sub>H8</sub> | C   | D          | E  | Bending strength | Surface durability | Bending strength | Surface durability |                        |  |                          |  |
| <b>SSR2-120</b>   | <b>m2</b>   | 120          | S5    | 194             | 240 | 244        | 20 | 366              | 44.0               | 37.4             | 4.49               |                        |  |                          |  |
| <b>SSR2-200</b>   |             | 200          | S5    | 354             | 400 | 404        | 20 | 630              | 84.2               | 64.3             | 8.59               |                        |  |                          |  |
| <b>SSR2.5-120</b> | <b>m2.5</b> | 120          | S5    | 245             | 300 | 305        | 25 | 715              | 88.5               | 72.9             | 9.02               |                        |  |                          |  |
| <b>SSR2.5-200</b> |             | 200          | S5    | 445             | 500 | 505        | 25 | 1230             | 169                | 126              | 17.2               |                        |  |                          |  |
| <b>SSR3-120</b>   | <b>m3</b>   | 120          | S5    | 296             | 360 | 366        | 30 | 1240             | 157                | 126              | 16.0               |                        |  |                          |  |
| <b>SSR3-160</b>   |             | 160          | S5    | 416             | 480 | 486        | 30 | 1680             | 226                | 171              | 23.0               |                        |  |                          |  |

| Backlash (mm) | Weight (kg) | Catalog No.       |
|---------------|-------------|-------------------|
| 0.17~0.37     | 2.46        | <b>SSR2-120</b>   |
| 0.20~0.41     | 4.28        | <b>SSR2-200</b>   |
| 0.19~0.41     | 4.62        | <b>SSR2.5-120</b> |
| 0.22~0.46     | 8.01        | <b>SSR2.5-200</b> |
| 0.22~0.45     | 7.77        | <b>SSR3-120</b>   |
| 0.22~0.45     | 10.6        | <b>SSR3-160</b>   |

[Caution on Product Characteristics]

- ① The allowable torques shown in the table are calculated values according to the assumed usage conditions. Please see page 35 for more details.
- ② The backlash values shown in the table are the theoretical values for the normal direction for the ring gear in mesh with a 30 tooth SS type spur gear.
- ③ Although the inside diameter of these gears are made to H8 tolerance, since the ring shape is easily deformed, some error may occur beyond the stated tolerance.

[Caution on Secondary Operations]

- ① Please read "Caution on Performing Secondary Operations" (Page 36) when performing modifications and/or secondary operations for safety concerns. Haguruma Kobo, the KHK's system for quick modification of KHK stock gears is also available.
- ② Avoid performing secondary operations that narrow the tooth width as it affects precision and strength.

Spur Gears  
Helical Gears  
Internal Gears  
Racks  
CP Racks & Pinions  
Miter Gears  
Bevel Gears  
Screw Gears  
Worm Gear Pair  
Bevel Gearboxes  
Other Products