

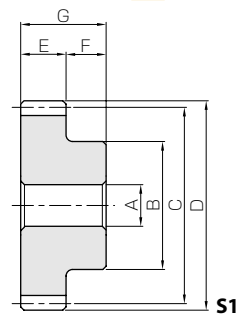

Specifications	
Precision grade	JIS grade N8 (JIS B1702-1: 1998) * JIS grade 4 (JIS B1702: 1976)
Gear teeth	Standard full depth
Pressure angle	20°
Material	S45C
Heat treatment	—
Tooth hardness	less than 194HB

\* The precision grade of products with a module of less than 0.8 is equivalent to the value shown in the table.



Spur Gears

Helical Gears

Internal Gears

Racks

CP Racks & Pinions

Miter Gears

Bevel Gears

Screw Gears

Worm Gear Pair

Bevel Gearboxes

Other Products

Catalog No.	Module	No. of teeth	Shape	Bore	Hub dia.	Pitch dia.	Outside dia.	Face width	Hub width	Total length	Keyway
				A <sub>H7</sub>	B	C	D	E	F	G	Width×Depth
SSY0.8-20 SSY0.8-20A	m0.8	20	S1	5	13.5	16	17.6	4	8	12	—
			S1T	5							—
			S1	5							—
			S1T	5							—
			S1	5							—
SSY0.8-25 SSY0.8-25A	m0.8	25	S1	5	17	20	21.6	4	8	12	—
			S1T	5							—
			S1	5							—
			S1T	5							—
			S1	5							—
SSY0.8-30 SSY0.8-30A	m0.8	30	S1	5	20	24	25.6	4	8	12	—
			S1T	5							—
			S1	5							—
			S1T	5							—
			S1	5							—
SSY0.8-40 SSY0.8-40A	m0.8	40	S1	5	25	32	33.6	4	8	12	—
			S1T	6							—
			S1	5							—
			S1T	6							—
			S1	5							—
SSY0.8-50 SSY0.8-50A	m0.8	50	S1	5	25	40	41.6	4	8	12	—
			S1T	6							—
			S1	5							—
			S1T	6							—
			S1	5							—
SSY1-12 SSY1-12A	m1	12	S1	5	9	12	14	6	8	14	—
			S1T	5							—
SSY1-14 SSY1-14A		14	S1	5	11	14	16	6	8	14	—
			S1T	5							—
SSY1-15 SSY1-15A		15	S1	6	12	15	17	6	8	14	—
			S1T	6							—
SSY1-16 SSY1-16A		16	S1	6	13	16	18	6	8	14	—
			S1T	6							—
SSY1-18 SSY1-18A		18	S1	6	14	18	20	6	8	14	—
			S1T	6							—
SSY1-20 SSY1-20A SSY1-20B		20	S1	6	16	20	22	6	8	14	—
			S1T	6							—
			S1T	8							—
SSY1-24 SSY1-24A SSY1-24B		24	S1	6	16	24	26	6	8	14	—
			S1T	6							—
			S1T	8							—
SSY1-25 SSY1-25A		25	S1	6	16	25	27	6	8	14	—
			S1T	6							—
SSY1-28 SSY1-28A		28	S1	6	16	28	30	6	8	14	—
			S1T	6							—
SSY1-30 SSY1-30A SSY1-30B	30	S1	6	25	30	32	6	8	14	—	
		S1T	6							—	
		S1T	8							—	
SSY1-32 SSY1-32A	32	S1	6	25	32	34	6	8	14	—	
		S1T	6							—	
SSY1-35 SSY1-35A SSY1-35B	35	S1	6	25	35	37	6	8	14	—	
		S1T	8							—	
		S1K	10							4 x 1.8	
SSY1-36 SSY1-36A SSY1-36B	36	S1	6	25	36	38	6	8	14	—	
		S1T	8							—	
		S1K	10							4 x 1.8	
SSY1-40 SSY1-40A SSY1-40B	40	S1	8	28	40	42	6	8	14	—	
		S1T	8							—	
		S1K	10							4 x 1.8	
SSY1-45 SSY1-45A	45	S1	8	28	45	47	6	8	14	—	
		S1T	8							—	
SSY1-48 SSY1-48A	48	S1	8	28	48	50	6	8	14	—	
		S1T	8							—	

[Caution on Product Characteristics] ① For products with a tapped hole, a set screw is included.  
 ② The allowable torques shown in the table are calculated values according to the assumed usage conditions. Please see page 35 for more details.  
 ③ The backlash values shown in the table are the theoretical values for the backlash in the normal direction of a pair of identical gears in mesh.

## Steel Thin Face Spur Gears

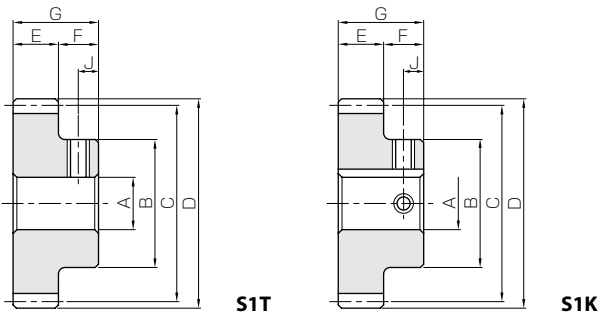

S1T

S1K

Set Screw		Allowable torque (N·m)		Allowable torque (kgf·m)		Backlash (mm)	Weight (kg)	Catalog No.
Size	J	Bending strength	Surface durability	Bending strength	Surface durability			
— M4	— 4	1.47	0.085	0.15	0.0087	0 ~0.10	490 690	<b>SSY0.8-20</b> <b>SSY0.8-20A</b>
— M4	— 4	2.03	0.134	0.21	0.014	0 ~0.10	530 730	<b>SSY0.8-25</b> <b>SSY0.8-25A</b>
— M4	— 4	2.60	0.197	0.27	0.020	0 ~0.10	610 790	<b>SSY0.8-30</b> <b>SSY0.8-30A</b>
— M4	— 4	3.77	0.362	0.39	0.037	0 ~0.10	750 950	<b>SSY0.8-40</b> <b>SSY0.8-40A</b>
— M4	— 4	4.98	0.580	0.51	0.059	0 ~0.10	920 1,150	<b>SSY0.8-50</b> <b>SSY0.8-50A</b>
— M4	— 4	1.22	0.069	0.12	0.0070	0.08~0.18	340 490	<b>SSY1-12</b> <b>SSY1-12A</b>
— M4	— 4	1.98	0.096	0.20	0.010	0.08~0.18	360 500	<b>SSY1-14</b> <b>SSY1-14A</b>
— M4	— 4	2.22	0.11	0.23	0.011	0.08~0.18	370 510	<b>SSY1-15</b> <b>SSY1-15A</b>
— M4	— 4	2.46	0.13	0.25	0.013	0.08~0.18	380 510	<b>SSY1-16</b> <b>SSY1-16A</b>
— M4	— 4	2.95	0.16	0.30	0.017	0.08~0.18	390 510	<b>SSY1-18</b> <b>SSY1-18A</b>
— M4 M5	— 4 4	3.45	0.20	0.35	0.021	0.08~0.18	420 560 560	<b>SSY1-20</b> <b>SSY1-20A</b> <b>SSY1-20B</b>
— M4 M5	— 4 4	4.48	0.30	0.46	0.030	0.08~0.18	450 590 590	<b>SSY1-24</b> <b>SSY1-24A</b> <b>SSY1-24B</b>
— M4	— 4	4.74	0.32	0.48	0.033	0.08~0.18	460 590	<b>SSY1-25</b> <b>SSY1-25A</b>
— M4	— 4	5.55	0.41	0.57	0.042	0.08~0.18	490 630	<b>SSY1-28</b> <b>SSY1-28A</b>
— M4 M5	— 4 4	6.08	0.47	0.62	0.048	0.08~0.18	500 660 660	<b>SSY1-30</b> <b>SSY1-30A</b> <b>SSY1-30B</b>
— M4	— 4	6.63	0.54	0.68	0.055	0.08~0.18	510 690	<b>SSY1-32</b> <b>SSY1-32A</b>
— M5 M4	— 4 4	7.45	0.66	0.76	0.067	0.08~0.18	540 740 860	<b>SSY1-35</b> <b>SSY1-35A</b> <b>SSY1-35B</b>
— M5 M4	— 4 4	7.73	0.70	0.79	0.071	0.08~0.18	570 750 870	<b>SSY1-36</b> <b>SSY1-36A</b> <b>SSY1-36B</b>
— M5 M4	— 4 4	8.84	0.87	0.90	0.089	0.08~0.18	610 840 1,070	<b>SSY1-40</b> <b>SSY1-40A</b> <b>SSY1-40B</b>
— M5	— 4	10.3	1.12	1.05	0.11	0.08~0.18	690 940	<b>SSY1-45</b> <b>SSY1-45A</b>
— M5	— 4	11.1	1.28	1.13	0.13	0.08~0.18	780 1,020	<b>SSY1-48</b> <b>SSY1-48A</b>

[Caution on Secondary Operations]

- ① Please read "Caution on Performing Secondary Operations" (Page 36) when performing modifications and/or secondary operations for safety concerns. Haguruma Kobo, the KHK's system for quick modification of KHK stock gears is also available.
- ② When performing secondary operations, be aware of deflection and distortion as the tooth is thin in width; deflection might occur if heat treated.
- ③ Avoid performing secondary operations that narrow the tooth width as it affects precision and strength.



Specifications	
Precision grade	JIS grade N8 (JIS B1702-1: 1998) JIS grade 4 (JIS B1702: 1976)
Gear teeth	Standard full depth
Pressure angle	20°
Material	S45C
Heat treatment	—
Tooth hardness	less than 194HB

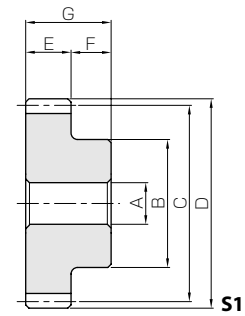

Spur Gears  
Helical Gears  
Internal Gears  
Racks  
CP Racks & Pinions  
Miter Gears  
Bevel Gears  
Screw Gears  
Worm Gear Pair  
Bevel Gearboxes  
Other Products

Catalog No.	Module	No. of teeth	Shape	Bore	Hub dia.	Pitch dia.	Outside dia.	Face width	Hub width	Total length	Keyway
				A <sub>H7</sub>	B	C	D	E	F	G	Width×Depth
<b>SSY1-50</b> <b>SSY1-50A</b>	<b>m1</b>	50	S1 S1T	8 8	28	50	52	6	8	14	— —
<b>SSY1-55</b> <b>SSY1-55A</b>		55	S1 S1K	8 10	28	55	57	6	8	14	— 4 x 1.8
<b>SSY1-56</b> <b>SSY1-56A</b>		56	S1 S1K	8 10	28	56	58	6	8	14	— 4 x 1.8
<b>SSY1-60</b> <b>SSY1-60A</b> <b>SSY1-60B</b>		60	S1 S1K S1K	8 10 12	35	60	62	6	8	14	— 4 x 1.8 4 x 1.8
<b>SSY1-64</b> <b>SSY1-64A</b>		64	S1 S1K	8 10	35	64	66	6	8	14	— 4 x 1.8
<b>SSY1-65</b> <b>SSY1-65A</b>		65	S1 S1K	8 10	35	65	67	6	8	14	— 4 x 1.8
<b>SSY1-70</b> <b>SSY1-70A</b>		70	S1 S1K	8 10	35	70	72	6	8	14	— 4 x 1.8
<b>SSY1-72</b> <b>SSY1-72A</b>		72	S1 S1K	8 10	35	72	74	6	8	14	— 4 x 1.8
<b>SSY1-75</b> <b>SSY1-75A</b>		75	S1 S1K	8 10	35	75	77	6	8	14	— 4 x 1.8
<b>SSY1-80</b> <b>SSY1-80A</b>		80	S1 S1K	10 12	40 35	80	82	6	8	14	— 4 x 1.8
<b>SSY1-85</b> <b>SSY1-85A</b>		85	S1 S1K	10 12	40 35	85	87	6	8	14	— 4 x 1.8
<b>SSY1-90</b> <b>SSY1-90A</b>		90	S1 S1K	10 12	40 35	90	92	6	8	14	— 4 x 1.8
<b>SSY1-95</b> <b>SSY1-95A</b>		95	S1 S1K	10 12	40 35	95	97	6	8	14	— 4 x 1.8
<b>SSY1-96</b> <b>SSY1-96A</b>		96	S1 S1K	10 12	40 35	96	98	6	8	14	— 4 x 1.8
<b>SSY1-100</b> <b>SSY1-100A</b>		100	S1 S1K	10 12	50 35	100	102	6	8	14	— 4 x 1.8
<b>SSY1-110</b> <b>SSY1-110A</b>		110	S1 S1K	10 12	50 35	110	112	6	8	14	— 4 x 1.8
<b>SSY1-120</b> <b>SSY1-120A</b>	120	S1 S1K	10 12	50 35	120	122	6	8	14	— 4 x 1.8	

[Caution on Product Characteristics]

- ① For products with a tapped hole, a set screw is included.
- ② The allowable torques shown in the table are calculated values according to the assumed usage conditions. Please see page 35 for more details.
- ③ The backlash values shown in the table are the theoretical values for the backlash in the normal direction of a pair of identical gears in mesh.

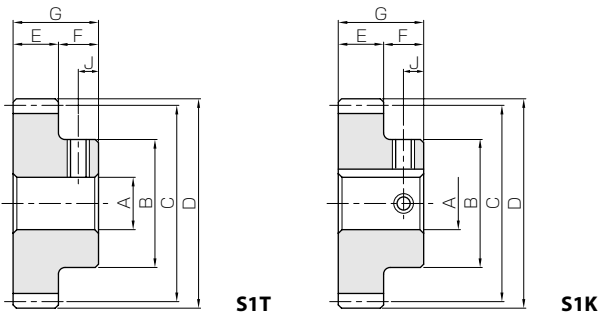

Spur Gears

Helical Gears

Internal Gears

Racks

CP Racks & Pinions

Miter Gears

Bevel Gears

Screw Gears

Worm Gear Pair

Bevel Gearboxes

Other Products

Set Screw		Allowable torque (N-m)		Allowable torque (kgf-m)		Backlash (mm)	Weight (kg)	Catalog No.
Size	J	Bending strength	Surface durability	Bending strength	Surface durability			
M5	4	11.7	1.39	1.19	0.14	0.08~0.18	0.13 0.12	SSY1-50 SSY1-50A
M4	4	13.1	1.70	1.34	0.17	0.08~0.18	0.15 0.14	SSY1-55 SSY1-55A
M4	4	13.4	1.77	1.37	0.18	0.08~0.18	0.15 0.14	SSY1-56 SSY1-56A
M4	4	14.5	2.04	1.48	0.21	0.08~0.18	0.19 0.18 0.18	SSY1-60 SSY1-60A SSY1-60B
M4	4	15.7	2.34	1.60	0.24	0.08~0.18	0.21 0.20	SSY1-64 SSY1-64A
M4	4	16.0	2.41	1.63	0.25	0.08~0.18	0.21 0.21	SSY1-65 SSY1-65A
M4	4	17.4	2.82	1.78	0.29	0.08~0.18	0.24 0.23	SSY1-70 SSY1-70A
M4	4	18.0	2.99	1.84	0.30	0.08~0.18	0.25 0.24	SSY1-72 SSY1-72A
M4	4	18.9	3.26	1.93	0.33	0.08~0.18	0.26 0.26	SSY1-75 SSY1-75A
M4	4	20.3	3.74	2.07	0.38	0.08~0.18	0.31 0.28	SSY1-80 SSY1-80A
M4	4	21.8	4.25	2.22	0.43	0.08~0.18	0.34 0.31	SSY1-85 SSY1-85A
M4	4	23.3	4.79	2.37	0.49	0.08~0.18	0.37 0.35	SSY1-90 SSY1-90A
M4	4	24.7	5.37	2.52	0.55	0.08~0.18	0.40 0.38	SSY1-95 SSY1-95A
M4	4	25.0	5.49	2.55	0.56	0.08~0.18	0.41 0.39	SSY1-96 SSY1-96A
M4	4	26.2	5.98	2.67	0.61	0.08~0.18	0.48 0.42	SSY1-100 SSY1-100A
M4	4	29.1	7.31	2.97	0.75	0.08~0.18	0.56 0.49	SSY1-110 SSY1-110A
M4	4	32.1	8.80	3.27	0.90	0.08~0.18	0.65 0.58	SSY1-120 SSY1-120A

[Caution on Secondary Operations]

- ① Please read "Caution on Performing Secondary Operations" (Page 36) when performing modifications and/or secondary operations for safety concerns. Haguruma Kobo, the KHK's system for quick modification of KHK stock gears is also available.
- ② When performing secondary operations, be aware of deflection and distortion as the tooth is thin in width; deflection might occur if heat treated.
- ③ Avoid performing secondary operations that narrow the tooth width as it affects precision and strength.